

Technical specification

Mounting torque: max. 25 Nm
Ambient temperature: -40°C ... +125°C
Media temperature: -40°C ... +125°C

Type label description

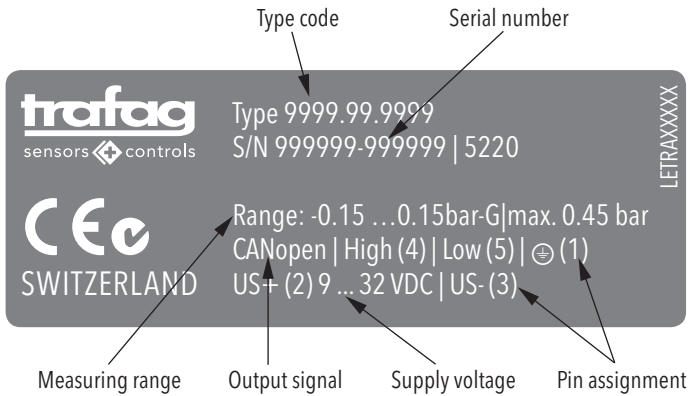

Electrical connections

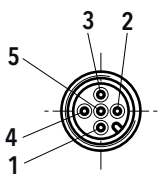

Pin	Out
1	⊖
2	Us+ (24VDC)
3	Us- (0 VDC)
4	CAN_High
5	CAN_Low

CANopen-protocol

Output signal: CAN BUS (ISO 118982)
CANopen: DS-301 V4.0
Device profile: DS 404-1 V1.2
Baudrate: 10 kbit/s
20 kbit/s
50 kbit/s
125 kbit/s
250 kbit/s
500 kbit/s
800 kbit/s
1 Mbit/s
Automatic bit rate detection
Node ID: 1 ... 127

Electrical connection

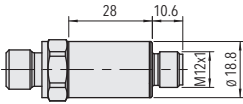

8271.XX.XXXX[35].XX.XX

Pressure connections

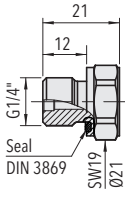

8271.XX.XX[17].XX

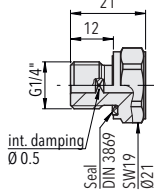

8271.XX.XX[15].XX

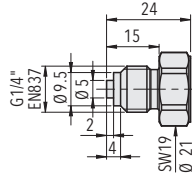

8271.XX.XX[53].XX

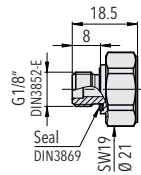

8271.XX.XX[54].XX

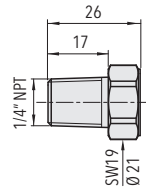

8271.XX.XX[30].XX

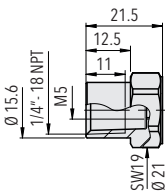

8271.XX.XX[13].XX

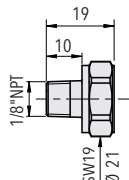

8271.XX.XX[43].XX

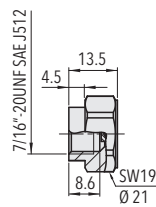

8271.XX.XX[24].XX

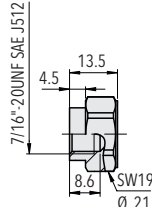

8271.XX.XX[44].XX

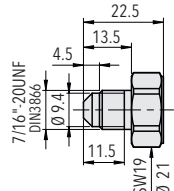

8271.XX.XX[18].XX

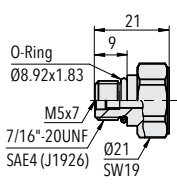

8271.XX.XX[42].XX

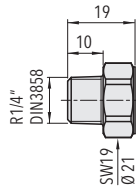

8271.XX.XX[19].XX

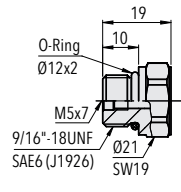

8271.XX.XX[61].XX

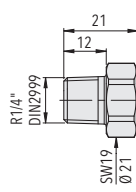

8271.XX.XX[20].XX

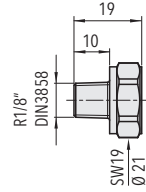

8271.XX.XX[16].XX

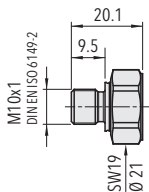

8271.XX.XX[32].XX

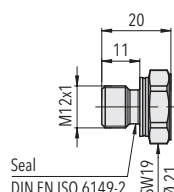

8271.XX.XX[64].XX

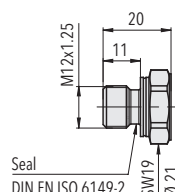

8271.XX.XX[65].XX

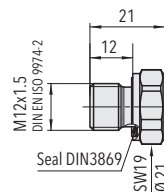

8271.XX.XX[49].XX

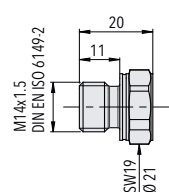

8271.XX.XX[31].XX