



# RCP

Robust linear sensor



RCP with GYSE-P (Profibus-sensor)

Regasense® is a trademark of Regal for position sensors. The RCP sensor is one of these.

When a robust encoder is required to handle tough environments and where it should not be integrated into the hydraulic system, Regal has the opportunity to adapt it completely to the customer's proposal.

These are based on a standard cylinder that can be obtained with most types of cylinder sensors in our range. You can choose between painted steel or stainless steel.

Today it is installed in heavy industry such as foundries and steel mills. Other applications include this system for bridges and stainless steel ports.

See our datasheets for selecting cylinder sensors for RCP on our website [www.regal.se](http://www.regal.se).

- Robust
- Heavy-Duty
- High Quality

## ORDER INFORMATION

RCP - □□□□ - □□□□

### Type of sensor

PS63  
PS65  
RCL40  
GY-mini  
GYSE  
GYSE-P  
GYcAT  
GYcAT4  
GYcRS  
GYMA

Stroke length mm

# RCP

Robust linear sensor

## Dimensions for mounting PS6300, PS6500, RCL40/41 och GY-mini

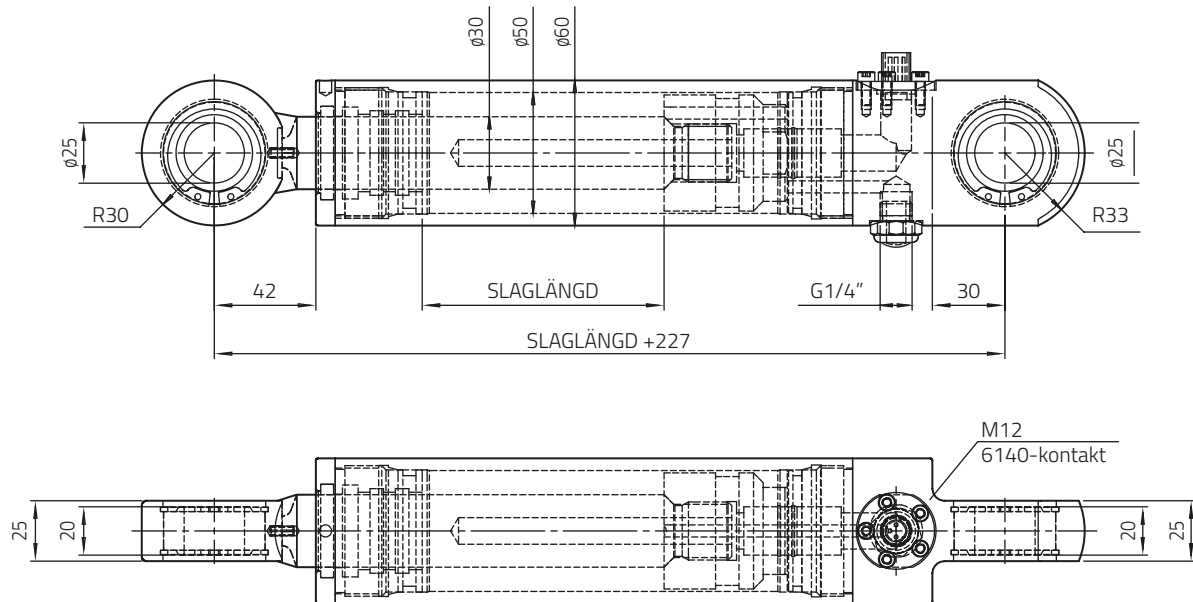

## Dimensions for mounting GYSE, GYcAT, GYcRS, GYMA

