

# KPA1-series

## Linear sensor 10-300 mm

With a housing just 18 mm wide, the KPA1 Series is designed for measuring applications in limited space. The joint with up-take of slack and M4 threading provides greater tolerances in movement. Careful selection of the materials and high-quality components used in KPA1 potentiometers ensure consistent measurement and reliable operation throughout the service life of the sensor.



- Robust
- Good quality price ratio
- Small dimensions

### SPECIFICATIONS

Model		10	15	25	50	75	100	125	150	175	200	225	250	275	300
Useful electric stroke (A.E.)	mm	10	15	25	50	75	100	125	150	175	200	225	250	275	300
Resistance (T.E.) ±10%	KΩ	1	1	1	5	5	5	5	5	5	5	5	5	5	5
Independant linearity (within A.E.)	±%	0,5	0,5	0,5	0,25	0,25	0,1	0,1	0,1	0,1	0,1	0,1	0,1	0,1	0,1
Mechanical stroke (M.T.)	mm	A.E. +3 mm													
Resolution		Infinite													
Repeatability	mm	0,01													
Electrical connections		3 pole PVC cable													
Displacement speed	m/s	≤ 5 (std)													
Protection level		IP67													
Life		-													
Displacement force	N	1,2													
Vibrations		5 - 2000Hz, Amax=0,75 mm, amax. = 20 g													
Shock		50 g, 11ms													
Recomended wiper current	μA	< 1													
Max. wiper current	mA	10													
Supply voltage	V	50													
Electrical isolation	MΩ	>10 at 500V, 2s, 1bar													
Dielectric strenght	μA	<100 at 500V~, 50Hz, 2s, 1bar													
Temperature coefficient	ppm/°C	≤1,5 (typical)													
Working temperature	°C	-60...+150													
Housing material		Anodized aluminum, Nylon 66 G 25													
Shaft material		Stainless steel AISI 303													
Mounting		Brackets with adjustable distance between centers or with M4 screw													

2015-09-09, specifications subject to change without notice

ISO 9001  
BUREAU VERITAS  
Certification



REGAL COMPONENTS AB • LEFFLERSGATAN 1 • SE-754 50 UPPSALA • SWEDEN  
+46 (0)18-65 70 00 • WWW.REGAL.SE • INFO@REGAL.SE

Regal

# KPA1-series

## Linear sensor 10-300 mm

### KPA1 DIMENSIONS

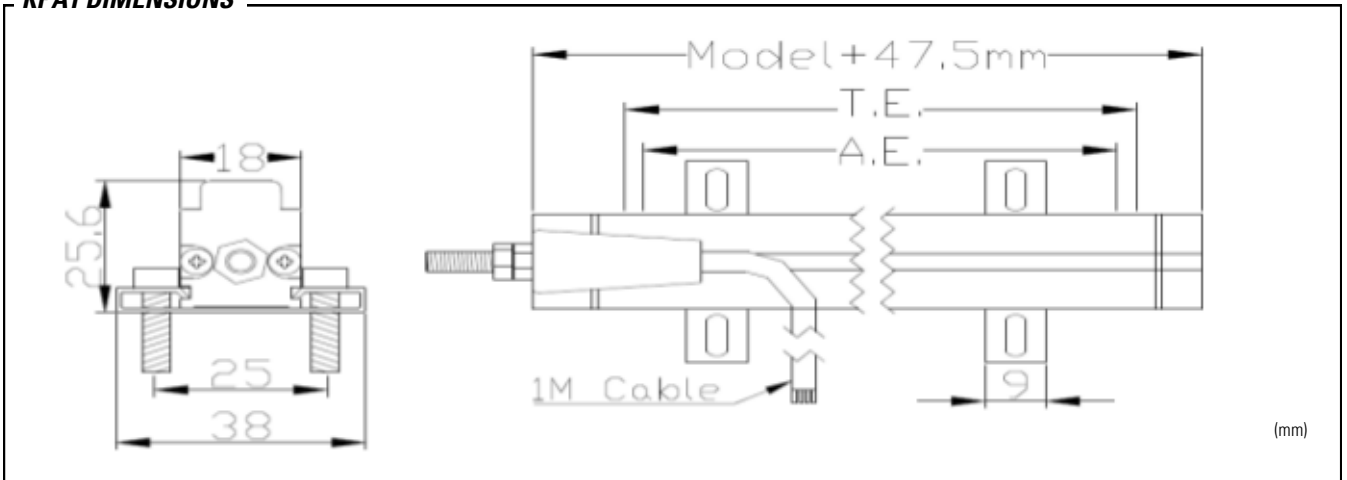

### BALL JOINT 1

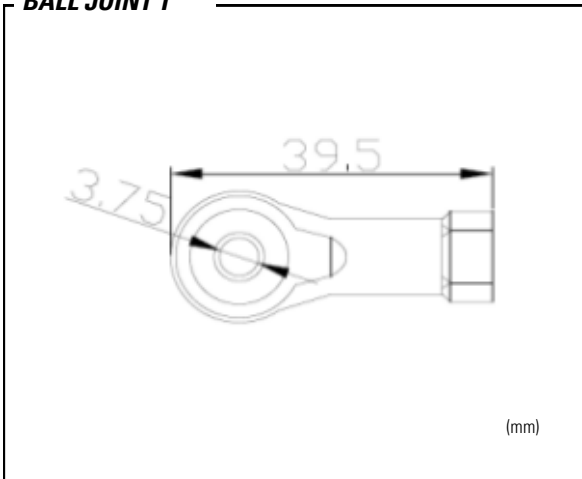

### BALL JOINT 2

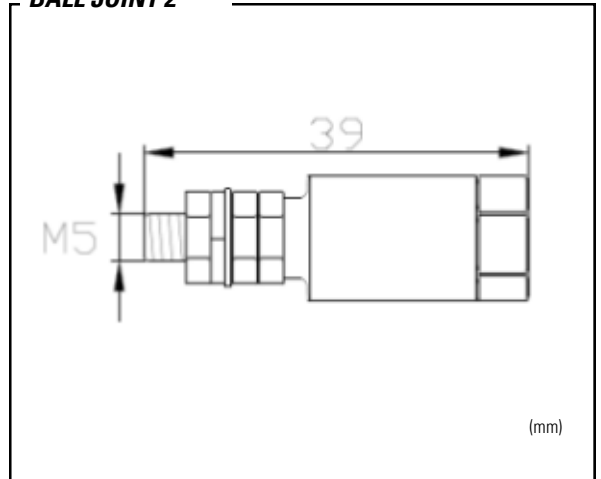

### ELECTRICAL CONNECTION

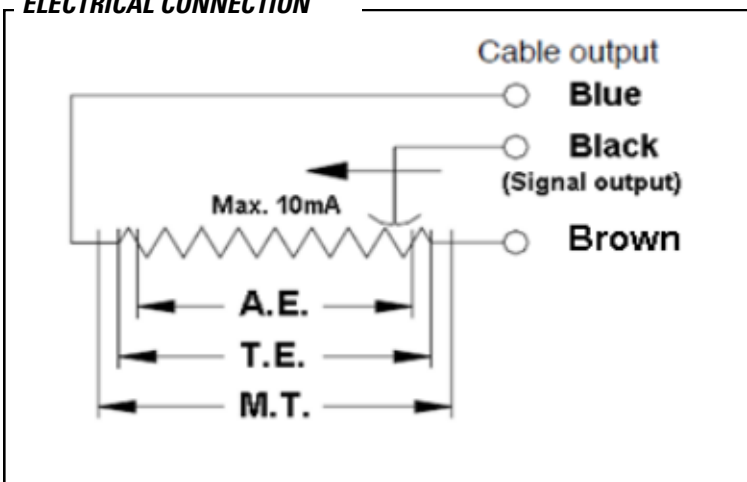

2015-09-09, specifications subject to change without notice

ISO 9001  
BUREAU VERITAS  
Certification



REGAL COMPONENTS AB • LEFFLERSGATAN 1 • SE-754 50 UPPSALA • SWEDEN  
+46 (0)18-65 70 00 • WWW.REGAL.SE • INFO@REGAL.SE

# Regal