

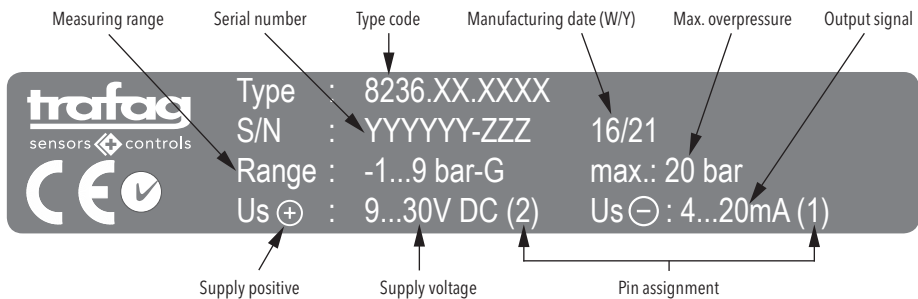

Technical specification

Mounting torque: 20 ... 25 Nm not lubricated / 15 ... 20 Nm lubricated
 Ambient temperature: -25°C ... +125°C
 Media temperature: -25°C ... +125°C
 Sealing temperature range: -15°C ... +125°C Mat. FPM (FKM)

Type label description

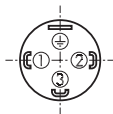
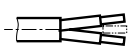
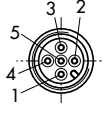

Electrical connections

Ingress Protection	IP65 ²⁾	IP68 max. 3m	IP67 ²⁾	IP67 ²⁾
Designation	EN175301-803A (DIN43650-A)	Cable* (PUR / PVC / Raychem) 4 x 0.25mm ²	M12x1 5-pol.	Packard Metri Pack 3-pol.
Type code	8236.XX.XXXX[05]	8236.XX.XXXX[08/22/24]	8236.XX.XXXX[35]	8236.XX.XXXX[51]
Pin configuration				

Output

4 ... 20 mA
 0 ... 5 VDC
 1 ... 6 VDC
 0 ... 10 VDC
 0.5 ... 4.5 VDC ratiom.

Load resistance

(U_{Supply}-9V)/ 20mA
 > 2.5 kΩ
 > 5.0 kΩ
 > 5.0 kΩ
 ≥ 5.0 kΩ

I_{SUPPLY}

< 10 mA
 < 10 mA
 < 10 mA
 ≤ 10 mA

U_{SUPPLY}

9... 32 VDC
 9... 32 VDC
 9... 32 VDC
 15... 32 VDC
 5 (4.75 ... 5.25) VDC

²⁾ provided female connector is mounted according to instructions

* Ventilation via cable end; shield in the device is not connected

Electrical connections / Pressure connection

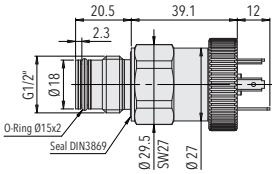

8236.XX.XX.93 **05**.XX.XX

Sealing temperature range:
-15°C ... +125°C Mat. FPM (FKM)

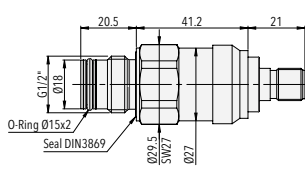

8236.XX.XX.93 **35**.XX.XX

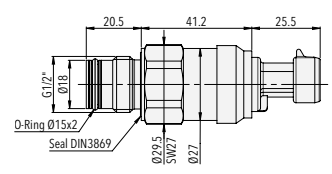

8236.XX.XX.93 **51**.XX.XX

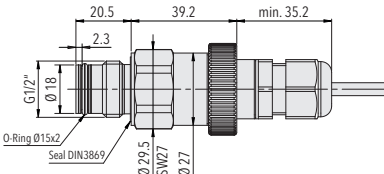

8236.XX.XX.93 **08/22/24**.XX.XX

Mounting thread G1/2"
DIN EN ISO 1179-1

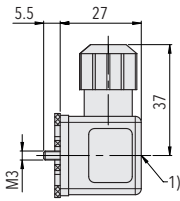
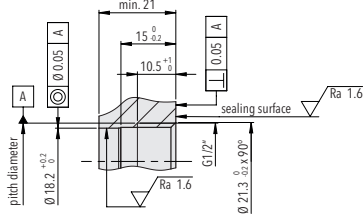

1) Tightening torque 50...60 Ncm

8236.XX.XXXX.XX.XX **46/56**

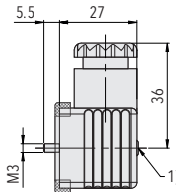

1) Tightening torque 50...60 Ncm

8236.XX.XXXX.XX.XX **58**

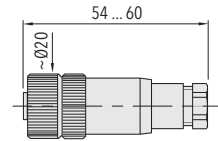

8236.XX.XXXX.XX.XX **33**

Connection of the measuring equipment

